

# XW-24/5XO-FPS-711

**Dual Band Circular Polarized WiFi Panel Antenna  
7 dBiC, 2400-2500 MHz 11 dBiC, 5000-6000 MHz**

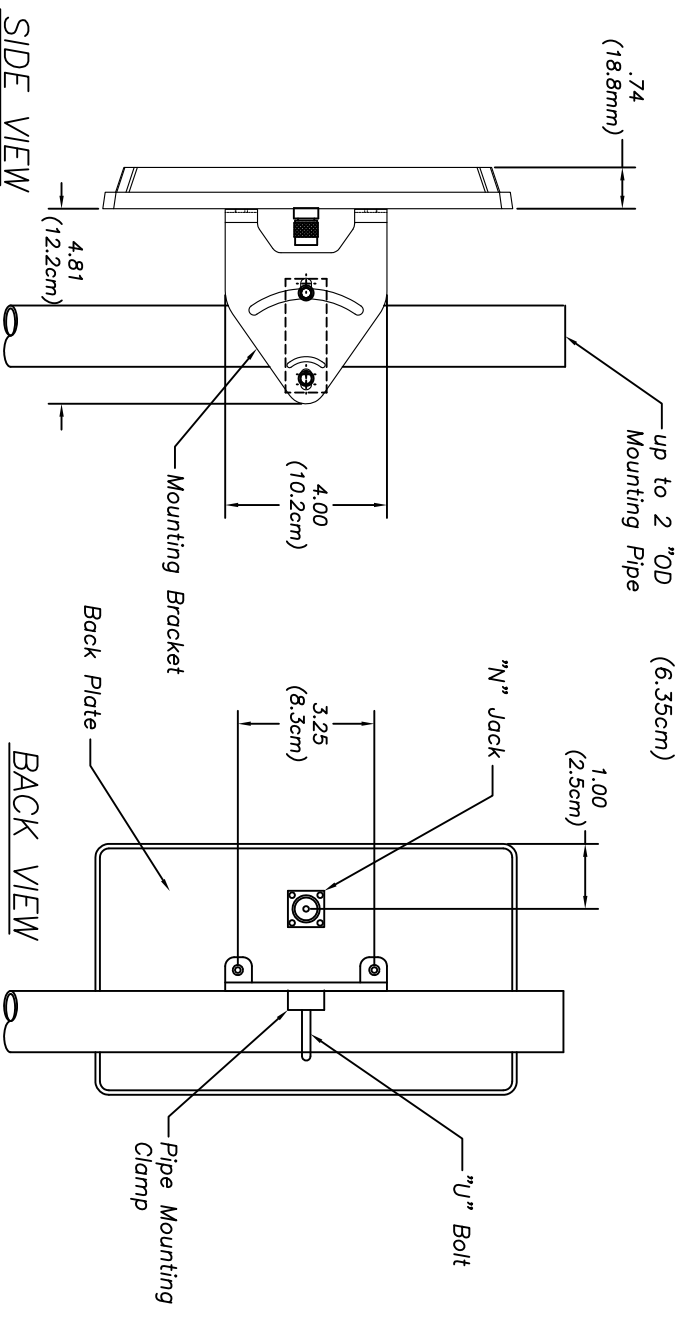
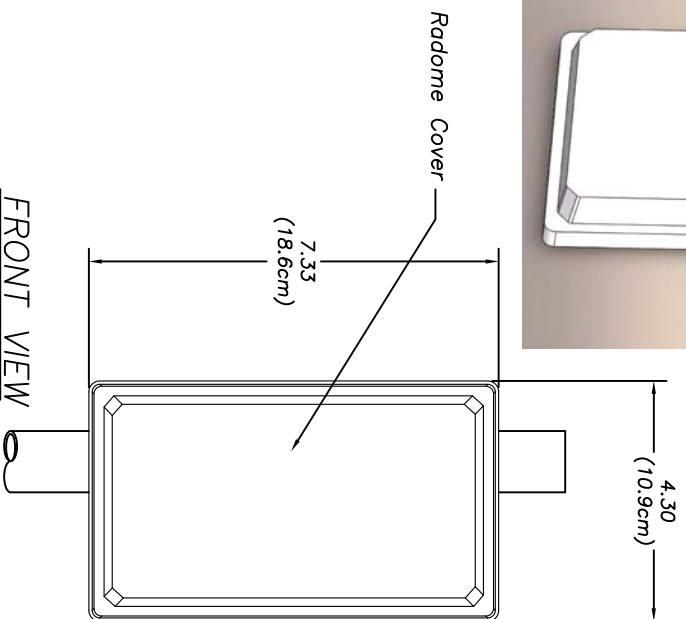
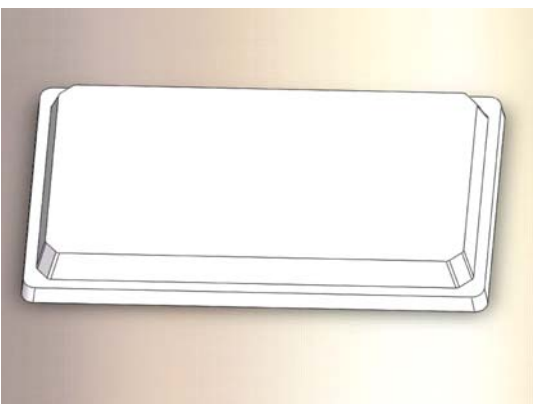

## Antenna Specifications:

Frequency:	2400–2500 MHz
	5000–6000 MHz
Gain:	7 dBiC Peak (2400–2500 MHz)
	11 dBiC Peak (5000–6000 MHz)
Beamwidth:	70° Azimuth, 40° Elevation
	70° Azimuth, 20° Elevation
Polarization:	RHCP, Axial Ratio <3dB
VSWR:	2:1
Radome Material:	White "ASA" Plastic
Nominal Impedance:	50 OHM Nominal
Maximum Power:	20 Watts
Connector:	N Jack
Mounting:	Standard Swivel Tilt Mounting
Operating Temperature:	-40°C to +85°C



**MobileMark**

antenna solutions

US OFFICE & HEADQUARTERS: 1140 W THORNDALE AVE, ITASCA, IL 60143  
 TEL: (847) 671-6690 \* FAX (847) 250-5120  
 UK OFFICE: 8 MIRAS BUS PARK, KEYS PARK ROAD, HEDNESFORD WS12 2FS, UK  
 UK TEL: (+44) 1543-459555 FAX (+44) 1543-459545  
 VISIT OUR WEBSITE AT WWW.MOBILEMARK.COM